

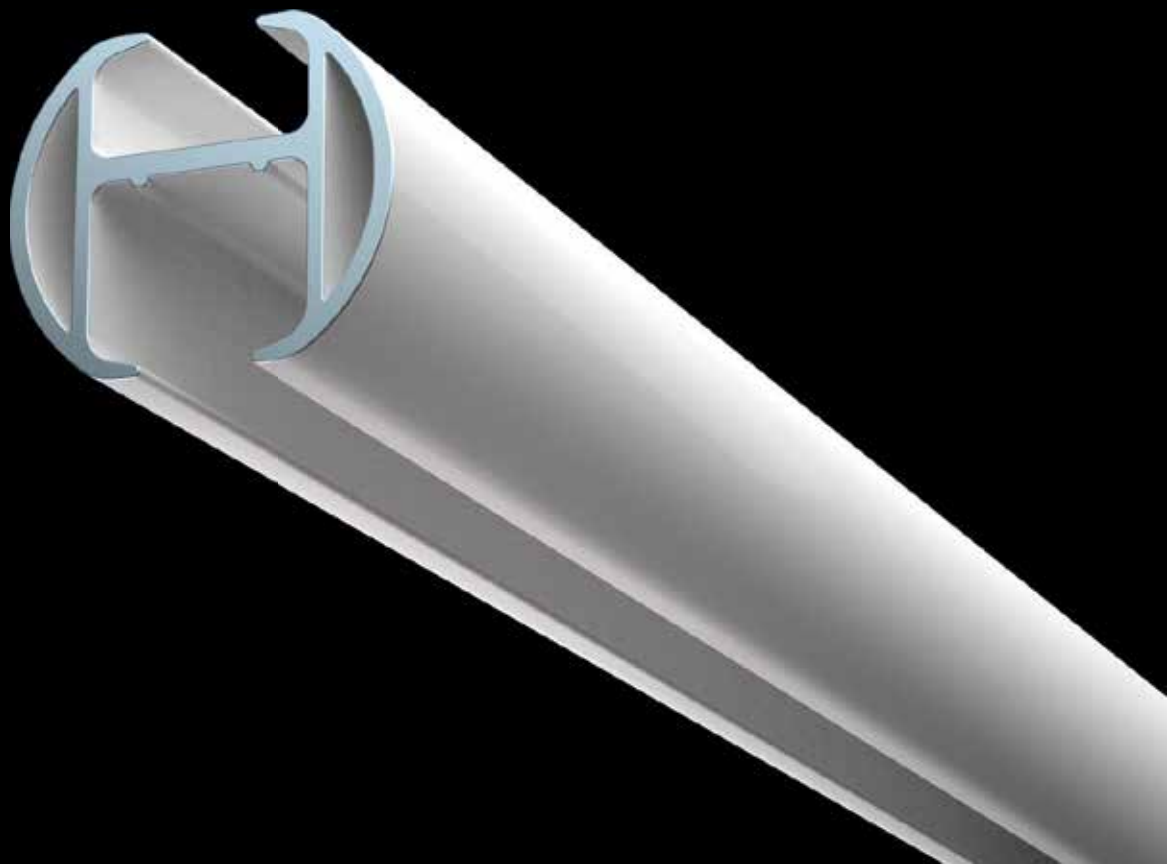

GOELST
curtain rail systems

Shower curtain rails

seamless quality





The standard in healthcare

For many years now, Goelst shower curtain rails have set the standard in healthcare applications. The quality and functionality of the rails, combined with years of experience, have earned Goelst its prominent position in this sector. Of course, Goelst shower rails are also ideal for use in private dwellings, hotels, and sports and educational facilities.

Shower rail

Shower rails can be either rectangular (type 4100) or rounded (types 4200 and 5100). Rail systems are crafted from a single section of rail, including curves in the running length, eliminating faltering rail connections and loose curves.

The water-resistant synthetic components and continuous aluminium profile ensure that shower curtains will always run smoothly. As rails can be shaped, they can also be applied to showers and baths with unusual forms (eg. corner baths).

Rails can be installed with ease by using our clever mounting accessories. All rail types can be either wall or ceiling mounted and can be supported below the ceiling using suspension hangers. Our technicians will take into account specific installation requirements, such as the possibility to integrate a patient hoist.

Goelst shower rails are available in a standard range of colours or can be RAL coloured by special request. The rails can be installed fully insulated against static electricity and can be equipped with a dust-cover strip to facilitate cleaning. Furthermore, it is possible to equip rail types 4100 and 5100 with LRS, an option developed for institutions with a heightened risk of strangulation.

Load Release System (LRS)

Goelst cubicle-, shower rails can be equipped with a Load Release System (LRS). This unique, patented system will release the rail from its activation points when it is subjected to a sudden peak load of 35 kg (subject to installation). The rail can subsequently be reinstalled without the need of specialist tools.

The Load Release System is our answer to a requirement of the healthcare sector. The need for collapsible, risk reducing rails became apparent, specifically in environments with a heightened ligature risk.

The components of the system have been designed for rail types 4100 and 5100. The LRS device is unobtrusive when the rail is in normal use.

Curtain rails are our expertise

Goelst is a Dutch manufacturer of aluminium curtain rail systems. With over thirty years of experience, we offer a comprehensive range of high-quality, versatile curtain rail systems, suitable for all curtain types.

Only the finest synthetics are used by our in-house injection moulding department for the manufacture of components. Goelst systems are known for their unparalleled gliding properties.

Bespoke products are our forte. As well as general customisation, we offer unique, customer-specific solutions. Our own R&D department and production facilities allow us to provide ongoing development and innovation. In short, Goelst provides the experience, facilities and ability to complete any rail-related challenge.

Types

- **4100:** a strong shower rail with a slim design.
- **4200:** an elegant, round shower rail.
- **5100:** a robust, round shower rail.

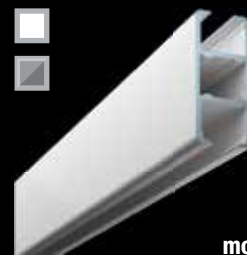

model 4100

the strong standard for shower curtain tracks
394 gr/m | 34 x 15 mm



model 4200

the elegant shower curtain track
288 gr/m | 18 x 21 mm



model 5100

the stable decorative shower curtain track
522 gr/m | 26 x 28 mm

Specification guide

Material

- Aluminium EN AW-6060-T66.
- Anodised in accordance with the Qualanod standard.
- Powder coated in accordance with the Qualicoat standard.

Accessories

Rotating glider with SS-hook 4007-60, 10 pcs per metre. Two endstops 4002 per length, spring stop 4003 and dust cover 4145.

Installation

Ceiling fixing with suspension hanger 4155 or 4255, mini suspension hanger 4254 or direct ceiling fixing with plate 4135 (4100, 4200) or 5135 (5100).

Face fixing with wall bracket 4141 or end fixing with support 4149 (4100), 4249 (4200) or 5149 (5100).

This system can also be mounted with anti-ligature Load Release components, to provide a controlled system collapse (4100 and 5100 only).

NEN-1010: Official standard for anti static rail installation.

Ceiling fixing with suspension hanger 4155 (using synthetic ceiling stud 4156) and wall fixing with synthetic wall support 4149, 4249 or 5149.

Bending

Minimum radius 4100: 20 cm, 4200 & 5100: 15 cm

Standard colours



9010



natural silver
anodised

other RAL colours & special coatings on request

Product example

standard shower rail designs and suspension hanger positions

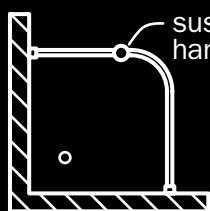

**L-shape
(shower)**

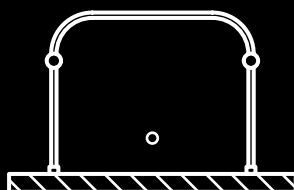

**U-shape
(shower)**



straight rail

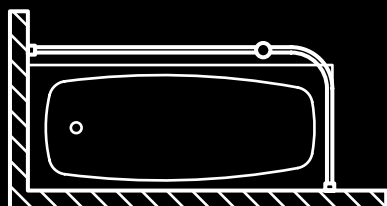

**L-shape
(oval bath)**

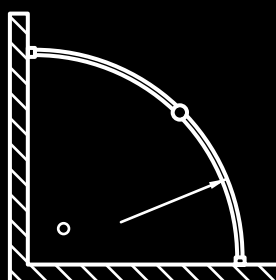

**specials
(corner baths)**



GOELST
curtain rail systems

Components

Curtain transport



4002
end stop without eye



4003
spring stop



4007
rotating glider



4007-60
rotating glider
with curtain hook

Ceiling mounting

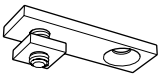

4135 (for 4100)
5135 (for 4200 & 5100)
ceiling bracket



4254
suspension hanger
3 cm



4155
suspension hanger
(4100 & 5100)

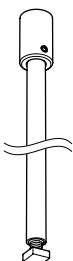

4255
suspension hanger
(4200)

Wall mounting

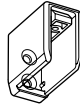

4149
wall bracket
(4100)



4249
wall bracket
(4200)



5149
wall bracket
(5100)

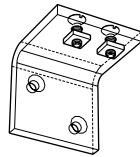

4140 (for 4100)
5140 (for 4200 & 5100)
wall bracket
transparent for anti
static installation
5 cm

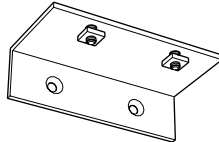

4141 (for 4100)
5141 (for 4200 & 5100)
wall bracket 5 cm

Accessories

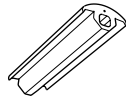

4145
dust cover

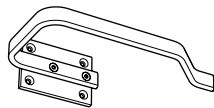

4170
curtain holdback
with fixing plate

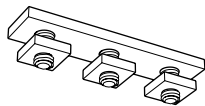

4130 (for 4100)
5130 (for 5100)
connection bracket

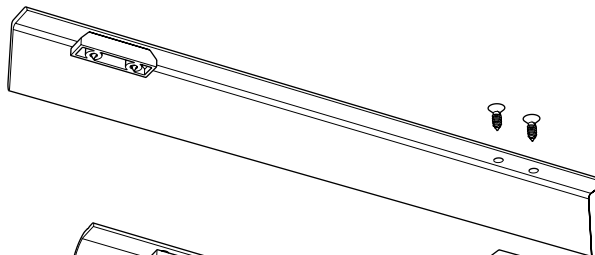

4165
connection bridge
(4100)

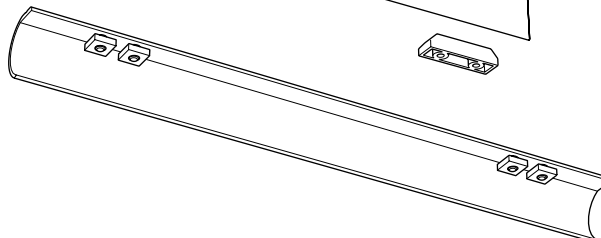

5165
connection bridge
(5100)

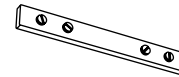

5152
connection bridge
(4200 & 5100)



5153-20
end cap hollow
in combination
with 5130
(5100)

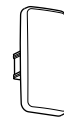

4153
end cap
(4100)



4253
end cap
(4200)



5153
end cap
(5100)

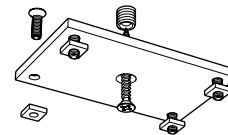

4116 (for 4100)
5116 (for 4200 & 5100)
bridging plate

Strong, stable and slim: shower rails by Goelst.



Goelst NL B.V.

P.O. Box 480 | 6710 BL Ede | The Netherlands | T +31 (0)318 648 100
F +31 (0)318 648 109 | info@goelst.com | www.goelst.com